

All dimensions are in mm except for the thread

6 D10 is [-78µm;+30µm]

20 H8 is [0 µm;+33µm]

Threading goes toward the chamfer

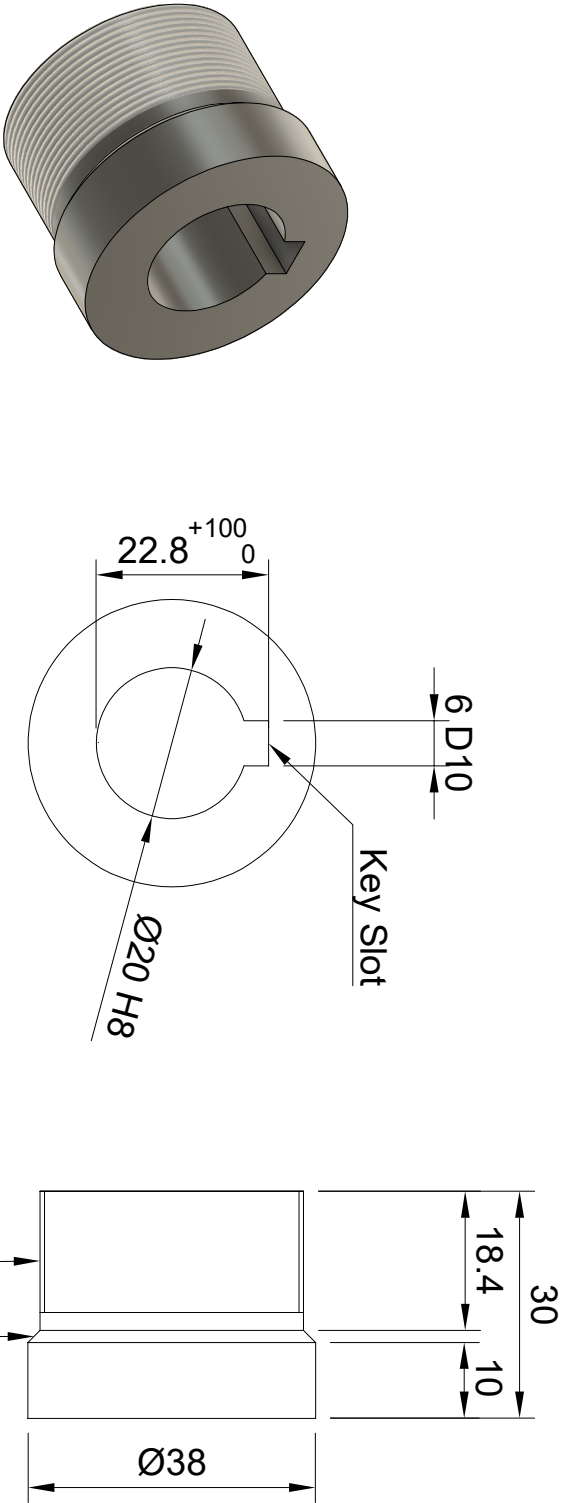

Thread for freewheel 1.375in x 24tpi

1.375in = 34.925mm

Major Diameter : [34.719 ; 34.899] [mm]
Minor Diameter : max 33,639mm
For info : Pitch Diameter [34,087 ; 34.212]

See ISO 6698

General Tolerances

Dimensions from 0.5 to 3 mm +-0.1 mm
Dimensions from 3 to 6 mm +-0.1 mm
Dimensions from 6 to 30 mm +-0.2 mm
Dimensions from 30 to 120 mm +- 0.3 mm

Dept.	Technical reference	Created by	Approved by		
Stainless Steel		Guis	13/03/2021		
		Document type	Document status		
		Title	DWG No.		
		Freewheel and disk brake adapter			
			Rev.	Date of issue	Sheet
			A	14/03/2021	1/1